



48" FULLY INTEGRATED SIDE-BY-SIDE REFRIGERATORS



DETAILED PLANNING DIMENSIONS GUIDE

(BASE UNIT REQUIRES SUITE-COORDINATING FULL HEIGHT PANEL KIT OR CUSTOM PANELS AND HANDLES)

JS48NFXDE – 47³/₄" (W) x 83" (H) x 24" (depth without door panels/handles)

BASE UNIT + FULL HEIGHT PANEL KIT = FINISHED REFRIGERATOR

Easily transform these overlay refrigerators into one of our signature kitchen suite designs with one of our suite-coordinating stainless steel panel kits. To do so, you must order one of the overlay base units (left column) and one of the suite-coordinating panel kits. The kits include refrigerator and freezer door panels, air grille and pre-installed handles.

Base Unit Model Number	Coordinating Stainless Full Height Panel Kits			
	RISE™ Stainless		NOIR™ Stainless	
Side-by-Side JS48NFXDE	JBSFS48NHL		JBSFS48NHM	

OPTIONAL ACCESSORIES FOR CUSTOM OVERLAY DESIGNS



ARMOIRE STYLE DOOR PANEL KIT

W 10663565 – 48" – Obsidian Interior

- For use with fully integrated and flush refrigerators
- Enables installation and proper venting of full height custom door panels (not included) that hide the top panel
- Includes left and right grille brackets and machine compartment cover



RISE™ STAINLESS HANDLE KIT

W 11231243 – 48" Side-by-Side

- For use with Custom Overlay fully integrated built-in refrigerators



NOIR™ STAINLESS HANDLE KIT

W 11194770 – 48" Side-by-Side

- For use with Custom Overlay fully integrated built-in refrigerators

Because Whirlpool Corporation policy includes a continuous commitment to improve our products, we reserve the right to change materials and specifications without notice.

Dimensions are for planning purposes only. For complete details, see Installation Instructions packed with product. Specifications subject to change without notice.



48" FULL INTEGRATED SIDE BY SIDE REFRIGERATORS

DETAILED PLANNING DIMENSIONS GUIDE

(BASE UNIT REQUIRES SUITE-COORDINATING FULL HEIGHT PANEL KIT OR CUSTOM PANELS AND HANDLES)

JS48NFXDE – 47³/₄" (W) x 83 1/2" (H) x 24" (depth without door panels/handles)

PRODUCT DIMENSIONS INCLUDING STAINLESS STEEL DOOR PANEL KIT DIMENSIONS

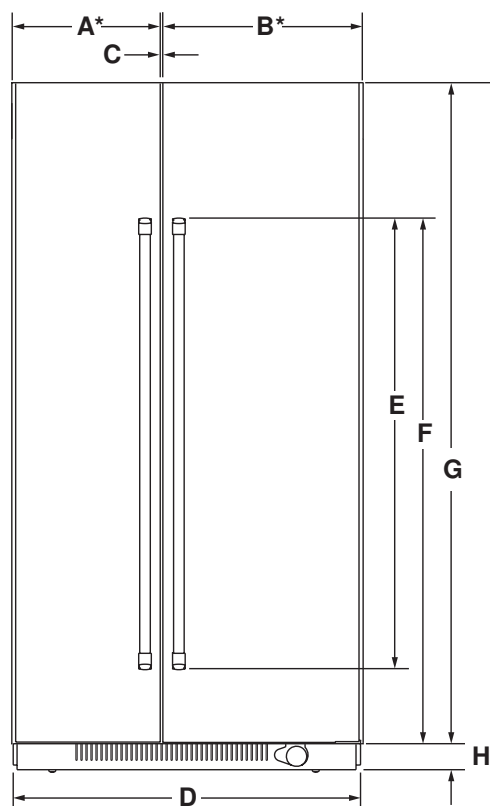

FRONT VIEW

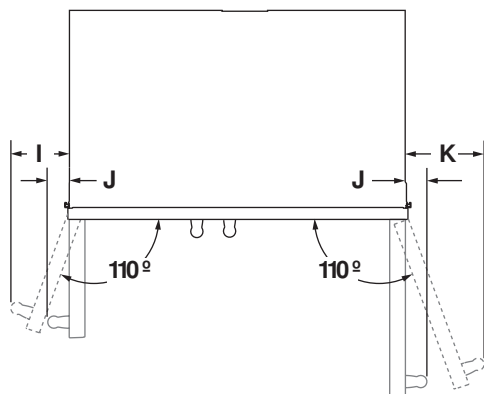

TOP VIEW

DIMENSION	DESCRIPTION	JS48NFXDE
A*	Width of freezer door	20 / " (51.6 cm)
B*	Width of refrigerator door	27 / " (69.4 cm)
C	Space between doors	1/8" (0.3 cm)
D	Overall width (including vinyl side trim)	47 3/4" (121.3 cm)
E	Height of door handle RISE™ Stainless	58" (147.3 cm)
	NOIR™ Stainless	40 / " (103.2 cm)
F	Height to top of door handle RISE™ Stainless	71 / " (182.1 cm)
	NOIR™ Stainless	69 / " (177.3 cm)
G	Height of door	81" (205.7 cm)
H	Height of bottom grille	3" (7.6 cm)
I	Width from side of refrigerator to freezer door handle – door fully open 110° RISE™ Stainless	8 1/2" (20.7 cm)
	NOIR™ Stainless	7 1/2" (19.3 cm)
J	Width from side of refrigerator to handle – door open 90° RISE™ Stainless	2 1/2" (6.1 cm)
	NOIR™ Stainless	1 1/2" (4.1 cm)
K	Width from side of refrigerator to refrigerator door handle – door fully open 110° RISE™ Stainless	10 1/2" (26.8 cm)
	NOIR™ Stainless	10 1/2" (25.5 cm)

*Door width dimensions are for stainless steel panel kit only.

Because Whirlpool Corporation policy includes a continuous commitment to improve our products, we reserve the right to change materials and specifications without notice.

Dimensions are for planning purposes only. For complete details, see Installation Instructions packed with product. Specifications subject to change without notice.



48" FULL INTEGRATED SIDE BY SIDE REFRIGERATORS

DETAILED PLANNING DIMENSIONS GUIDE

(BASE UNIT REQUIRES SUITE-COORDINATING FULL HEIGHT PANEL KIT OR CUSTOM PANELS AND HANDLES)

JS48NFXDE – 47³/₄" (W) x 83 / " (H) x 24" (depth without door panels/handles)

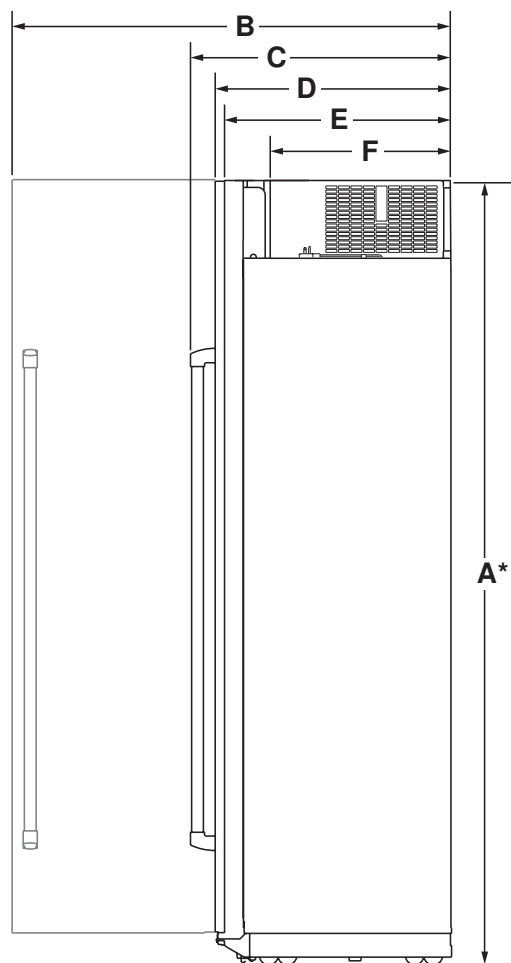

SIDE VIEW

DIMENSION	DESCRIPTION	JS48NFXDE
A*	Height of recessed refrigerator (min.)	83 / " (211.1 cm)
B	Depth with refrigerator door open 90° (min.)	50 / " (128.8 cm)
C	Depth with handles (min.)	
	RISE™ Stainless	27 / " (70.2 cm)
	NOIR™ Stainless	26 / " (68.2 cm)
D	Depth with doors (min.)	
	RISE™ Stainless	24 / " (62.8 cm)
	NOIR™ Stainless	24 / " (62.8 cm)
	Custom panel (3/4"/1.9 cm)	24 / " (62.8 cm)
E	Depth without door panel kit (min.)	24" (61 cm)
F	Depth of compressor cover (min.)	19 / " (50.5 cm)

*Add 1 / " (3.2 cm) to the height dimension when leveling legs are fully extended.



48" FULL INTEGRATED SIDE BY SIDE REFRIGERATORS

DETAILED PLANNING DIMENSIONS GUIDE

(BASE UNIT REQUIRES SUITE COORDINATING FULL HEIGHT PANEL KIT OR CUSTOM PANELS AND HANDLES)

JS48NXFXDE 47 1/4" (W) x 83 1/2" (H) x 24" (depth without door panels)

AIRFLOW VENTILATING RECOMMENDATIONS CLOSED SOFFIT CABINET

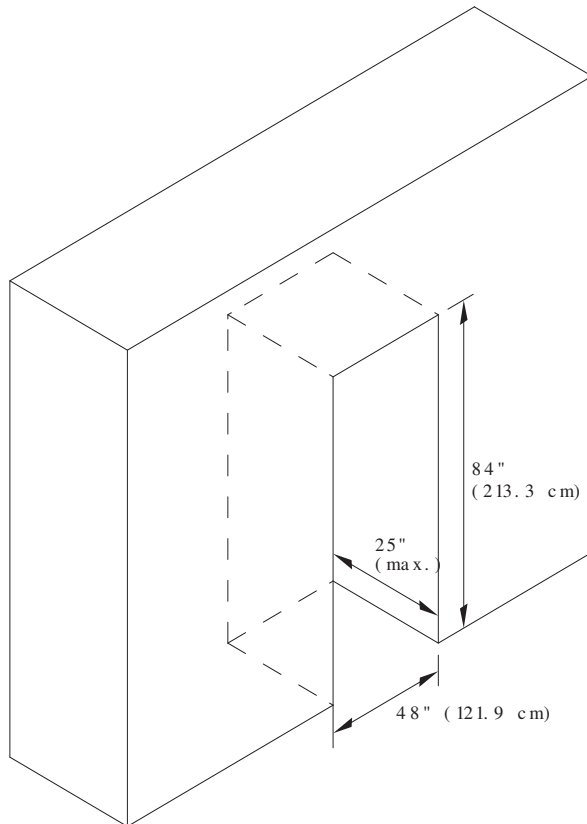

Depth of cabinet must be less than 25" (63.5 cm).
Height of soffit must not exceed 84" (213.3 cm).
Following illustrations explain the cabinet construction (soffit and rear wall positions) required for optimum ventilation and airflow.

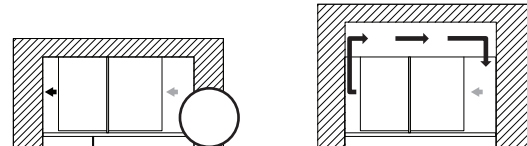

Top View

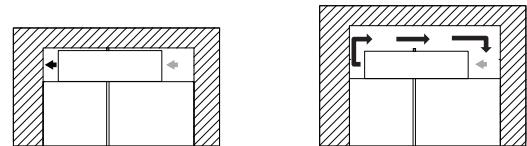

Front View

Grey arrow = ambient air; Black arrow = warm air
Cabinet depth 25" and soffit located at 84", Cabinet depth more than 25" and/or soffit located at more than 84", causes air gap at back of refrigerator. Efficient cooling is achieved, and/or top of the refrigerator. Air gap allows warm air recirculation causing loss in cooling efficiency.

If your opening does not meet these requirements you will need to make modifications.