

# KitchenAid® Food Waste Disposer

## PRODUCT MODEL NUMBER

KCDB250G    KCDS100T  
 KCDI075V    KBDS100T  
 KCDS075T

**Electrical:** This disposer is intended to be direct-wired to the electrical supply. If a junction box is used, connect the junction box to the switch on a separate 15- or 20-amp 115 Volt circuit with the appropriate cable. (Use 14 gauge wire with 15-amp circuit, and 12 gauge wire with 20-amp circuit.) This disposer requires a switch marked "Off" position (wired to disconnect all ungrounded supply conductors) installed within sight of the disposer sink opening. (1 hp minimum rating.)

## OVERALL DIMENSIONS

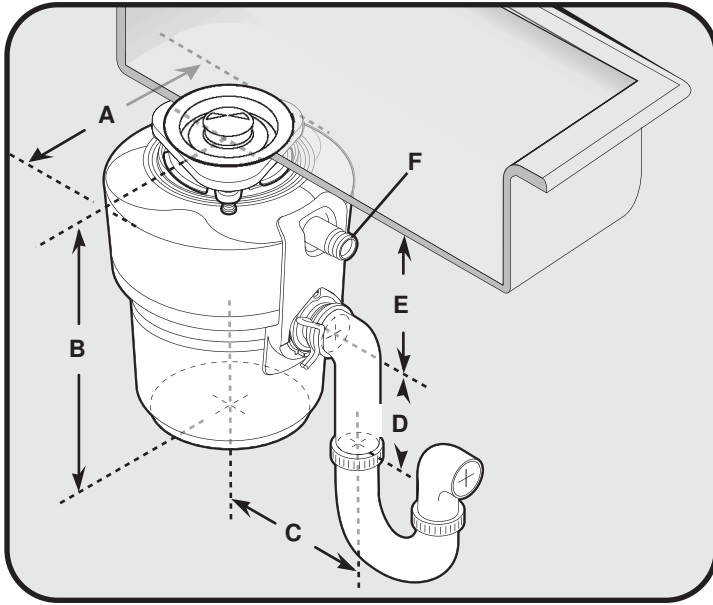

	KCDB250G	KCDI075V	KCDS075T	KCDS100T	KBDS100T
<b>A</b>	6 <sup>5</sup> / <sub>16</sub> " (16.0 cm)	8 <sup>1</sup> / <sub>2</sub> " (21.6 cm)	9" (22.9 cm)	9" (22.9 cm)	9" (22.9 cm)
<b>B</b>	11 <sup>3</sup> / <sub>8</sub> " (28.9 cm)	12 <sup>3</sup> / <sub>4</sub> " (30.5 cm)	12 <sup>3</sup> / <sub>4</sub> " (30.5 cm)	12 <sup>3</sup> / <sub>4</sub> " (30.5 cm)	15 <sup>1</sup> / <sub>2</sub> " (39.4 cm)
<b>C</b>	5 <sup>3</sup> / <sub>4</sub> " (14.6 cm)	5 <sup>3</sup> / <sub>4</sub> " (14.6 cm)	5 <sup>3</sup> / <sub>4</sub> " (14.6 cm)	5 <sup>3</sup> / <sub>4</sub> " (14.6 cm)	5 <sup>3</sup> / <sub>4</sub> " (14.6 cm)
<b>D</b>	4" (10.2 cm)	4" (10.2 cm)	4" (10.2 cm)	4" (10.2 cm)	4" (10.2 cm)
<b>E</b>	6" (15.2 cm)	6 <sup>11</sup> / <sub>16</sub> " (17 cm)	6 <sup>11</sup> / <sub>16</sub> " (17 cm)	6 <sup>11</sup> / <sub>16</sub> " (17 cm)	9 <sup>7</sup> / <sub>16</sub> " (24 cm)
<b>F</b>	Dishwasher Drain Connection				

Installations on thicker sinks (such as solid surface, porcelain, or cast iron) may require the use of alternate parts. See instructions below for installation with various thicknesses:

**FIGURE A: Thin Sink**  
 All Models  
 (< <sup>3</sup>/<sub>8</sub>" )

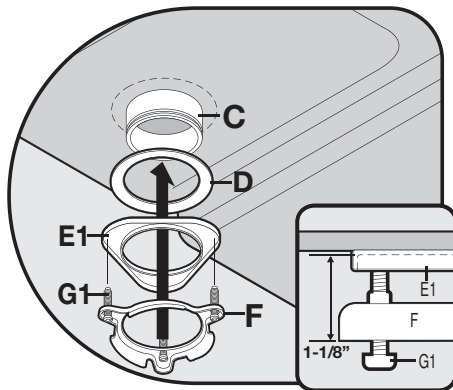

For thin sinks insert fiber gasket (D), backup flange (E1) and mounting ring (F). Hold in place while inserting the snap ring.

- C** = Standard Sink Flange
- G1** = 1 1/2" screws
- G2** = 1 1/8" screws

**FIGURE B: Thick Sink**  
 All Models  
 (> <sup>3</sup>/<sub>8</sub>" )

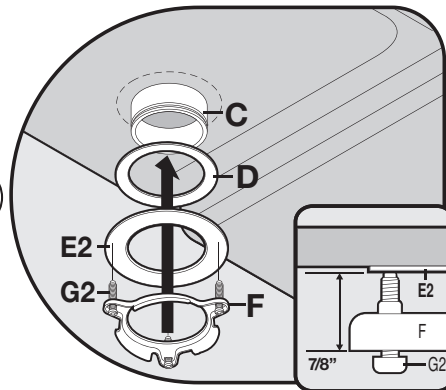

For thick sinks insert fiber gasket (D), backup flange (E2) and mounting ring (F). Hold in place while inserting the snap ring.

**FIGURE C: Extra Thick Sink**  
 For Model KBDS100T Only  
 (> <sup>3</sup>/<sub>4</sub>" )

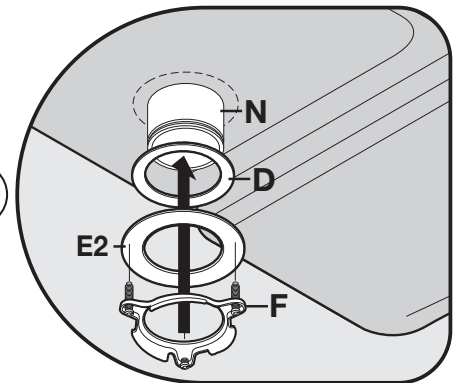

For extra thick sinks use extended sink flange (N), to order in US call 1-800-422-1230, in Canada call 1-800-6777. Insert fiber gasket (D), backup flange (E2) and mounting ring (F). Hold in place while inserting the snap ring.