



Beverage Center

PRODUCT MODEL NUMBER

WUB50X24HZ

Electrical: 115-Volt, 60-Hz, AC-only 15- or 20-amp fused, grounded electrical supply is required. It is recommended that a separate circuit serving only your beverage center be provided. Use an outlet that cannot be turned off by a switch. Do not use an extension cord.

NOTE: Before performing any type of installation, cleaning or removing a light bulb, unplug beverage center or disconnect power.

LOCATION REQUIREMENTS

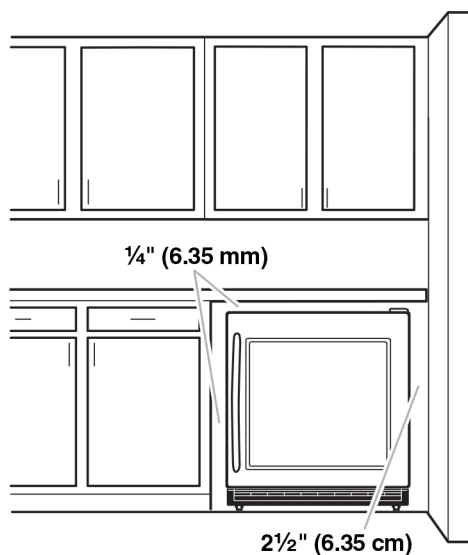

To ensure proper ventilation for your beverage center, allow for a $\frac{1}{4}$ " (6.35 mm) space on each side and at the top. When installing your beverage center next to a fixed wall, leave $2\frac{1}{2}$ " (6.35 cm) minimum clearance on each side to allow for the door to swing open.

NOTE: It is recommended that you do not install the beverage center near an oven, radiator, or other heat source. Do not install in a location where the temperature will fall below 55°F (13°C). For best performance, do not install the beverage center behind a cabinet door or block the base grille.

OVERALL DIMENSIONS

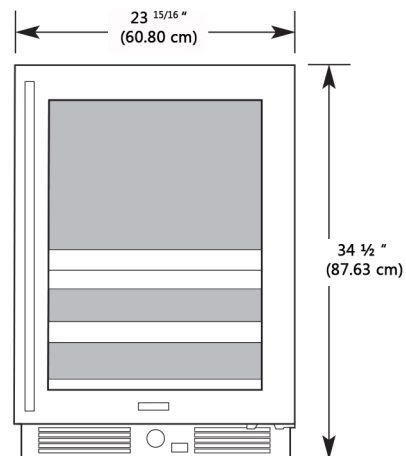

| | |
|---------------------------------------|--------------------------------|
| <i>Height to top of cabinet:</i> | $34\frac{1}{2}$ " (87.63 cm) |
| <i>Height to top of door hinge:</i> | 35" (88.9 cm) |
| <i>Width closed:</i> | $23\frac{15}{16}$ " (60.80 cm) |
| <i>Depth closed including handle:</i> | $25\frac{5}{8}$ " (65.08 cm) |
| <i>Depth closed excluding handle:</i> | 24" (60.96 cm) |
| <i>Depth excluding doors:</i> | $21\frac{5}{8}$ " (54.92 cm) |
| <i>Depth with doors open 90°:</i> | $46\frac{1}{4}$ " (117.47 cm) |